

ASPHALT • TYP. SECTION

N.T.S.

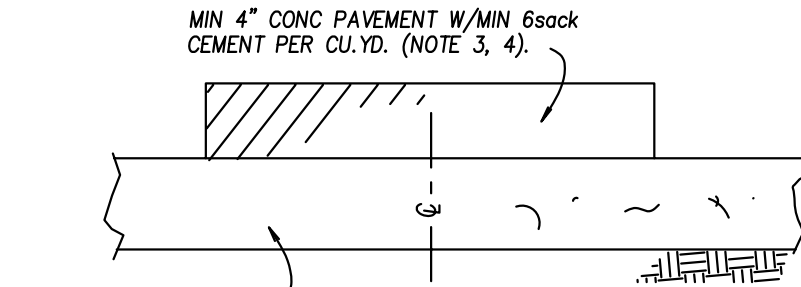

CONCRETE • TYP. SECTION

N.T.S.

NOTES

1. MIN SLOPE SHALL BE 1% ON ASPHALT AND 0.4% ON CONC.
2. SUBGRADE SHALL BE OVEREXCAVATED IN AREAS OF UNSTABLE OR EXPANSIVE SOILS.
3. STRUCTURAL SECTIONS FOR COMMERCIAL DRIVEWAYS, APRATMENTS & CONCOMINIUMS SHALL BE BASED UPON ENGINEERING DESIGN & GEOMETRICS.
4. CONC SHALL MEET REQUIREMENTS OF STD SPECS FOR PUBLIC WORKS CONSTRUCTION FOR CONC EXPOSED TO FREEZE/THAW ENVIRONMENTS.
5. THIS STANDARD APPLIES UP TO A MAX OF TWO RESIDENTIAL LOTS SERVED BY A SINGLE DRIVEWAY.
6. MIN 4" THICK FULL DEPTH ASPH SECTION W/FOG SEAL OR SLURRY SEAL MAY BE USED IN LIEU OF 2-1/2" ASPH ON 4" TYPE 2 CLASS B BASE.
7. FOR MIN WIDTHS W/IN COUNTY RIGHT-OF-WAY REF: DWG's. W-16.4, W-5.2, W-5.3

NO.	REVISED	DATE	STANDARD DETAILS FOR PUBLIC WORKS CONSTRUCTION	SECTION:	WASHOE	
			PRIVATE DRIVEWAY CONCRETE OR ASPHALT	DRAWING NO:	W-5.4	
				DATE: 8/94 vp	PAGE:	16